

HARDWARE

SPYKER KAT V2.1 / DUMP BUCKET / CAB KITS

This list contains all the hardware needed to build your tracked vehicle. You can order hardware kits at: www.spykerworkshop.com

Scale 1:1

SPYKER KAT HARDWARE

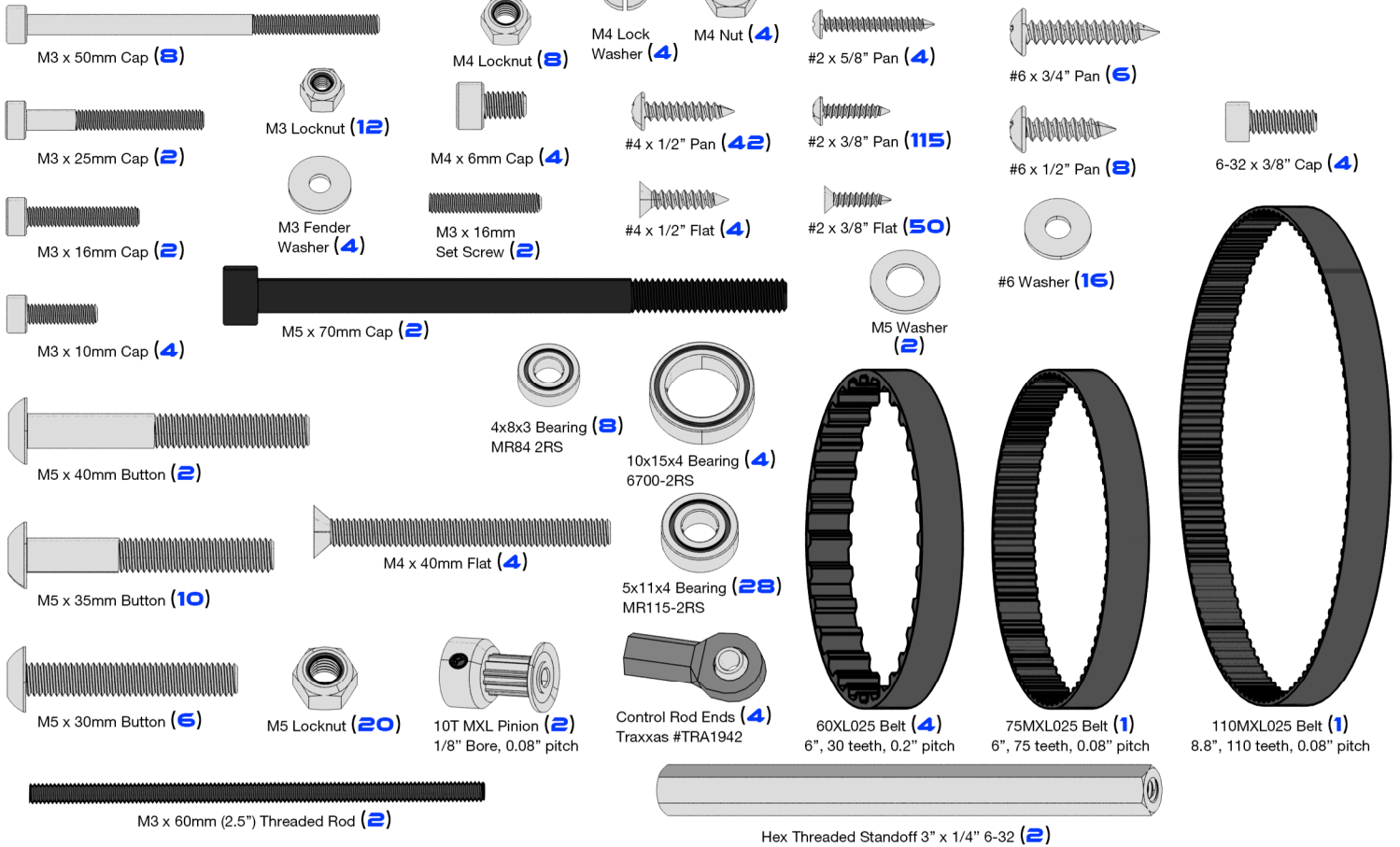

DUMP BUCKET HARDWARE

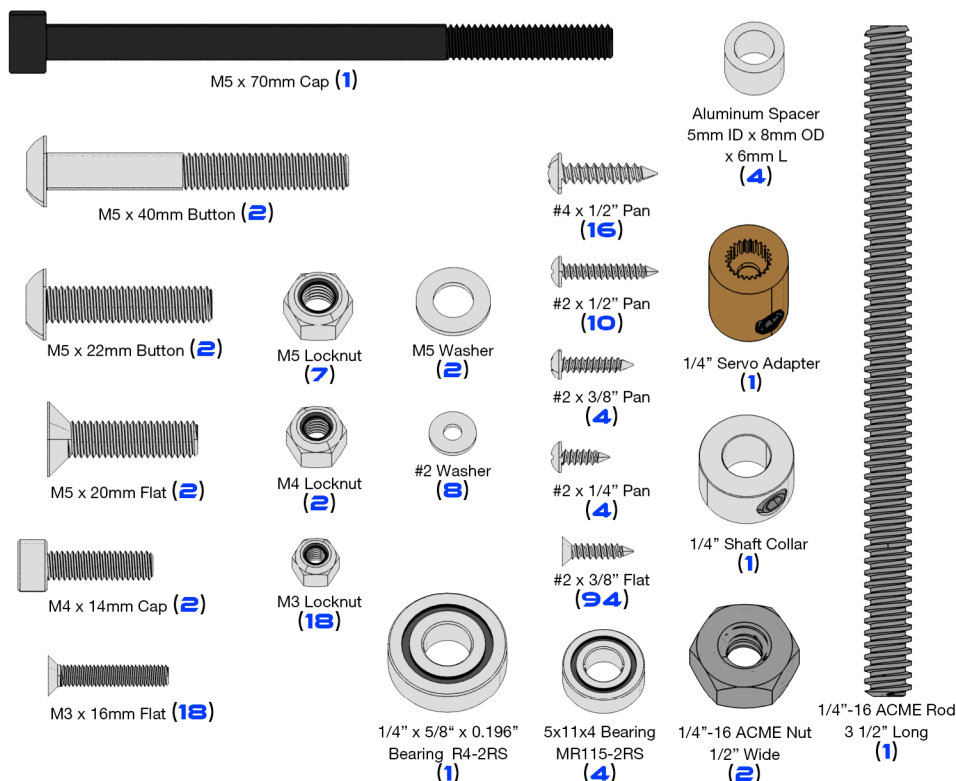

CAB HARDWARE

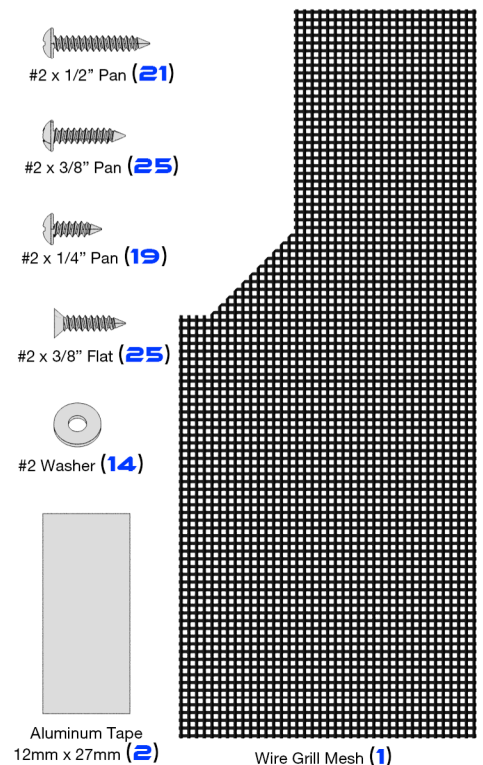

SPYKER KAT V2 DRILL GUIDE V2.1

TRACKED VEHICLE KIT

DRILL SIZE KEY

○ = Drill Hole

▽ = *Countersink

● - 5/64" (2.0mm)

● - 3/32" (2.4mm)

● - 1/8" (3.2mm)

● - 9/64" (3.6mm)

● - 5/32" (4.0mm)

● - 5mm

Drill with the sizes shown to avoid splitting or stripping out threads.

Some parts have a right and left, mirror drill holes to both sides.

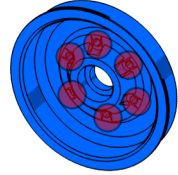

Wheel Hub A (10)

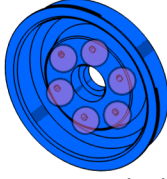

Wheel Hub B (10)

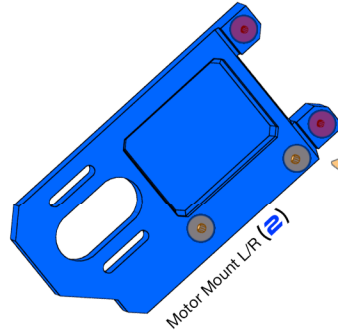

Motor Mount L/R (2)

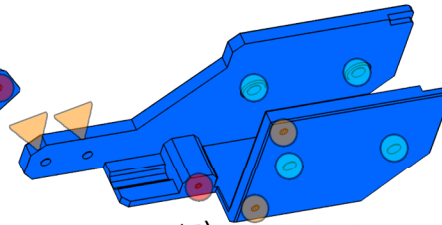

Transmission L/R (2)



Hex Spacer (2)

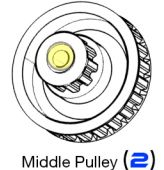

Middle Pulley (2)

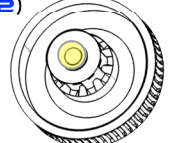

First Pulley (2)



Final Drive (2)

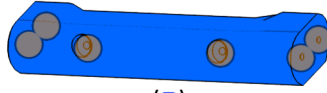

Mount Bar (2)

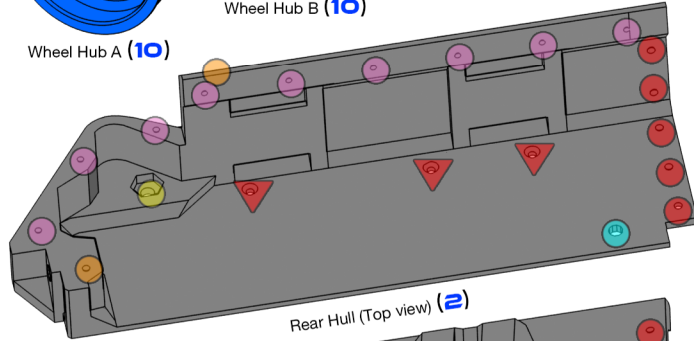

Rear Hull (Top view) (2)

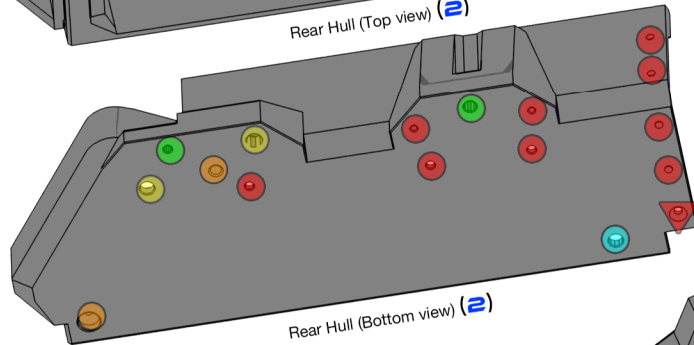

Rear Hull (Bottom view) (2)

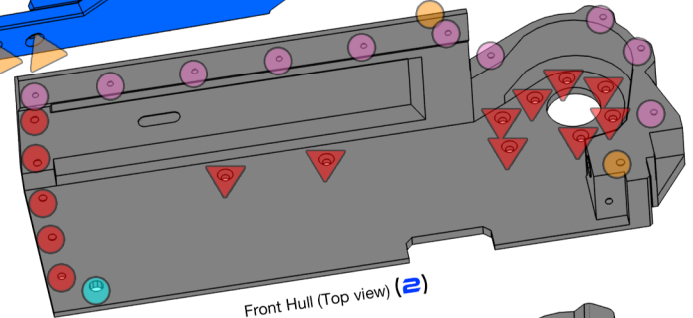

Front Hull (Top view) (2)

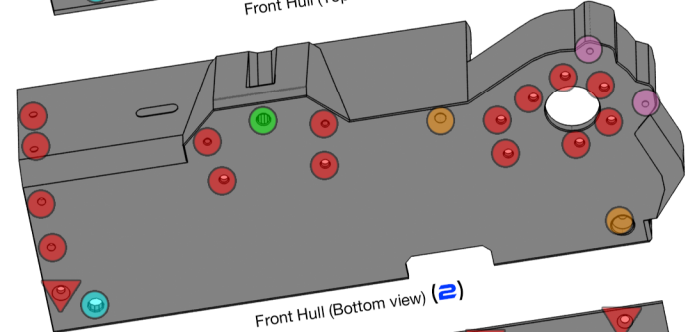

Front Hull (Bottom view) (2)

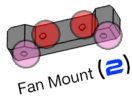

Fan Mount (2)



Bulkhead Clip



Cap (6)

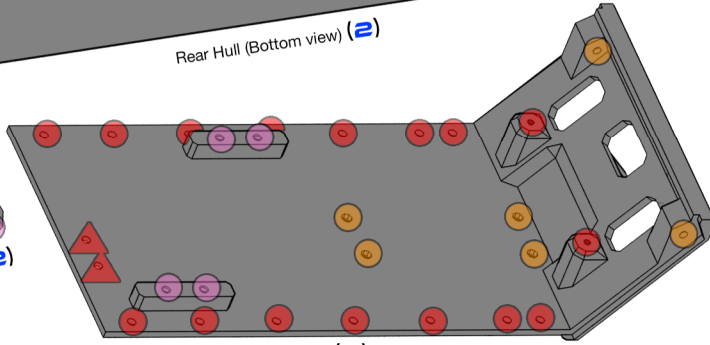

Hull (2)

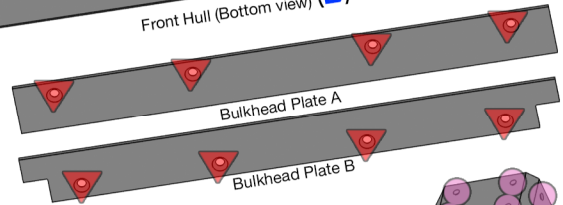

Bulkhead Plate A

Bulkhead Plate B

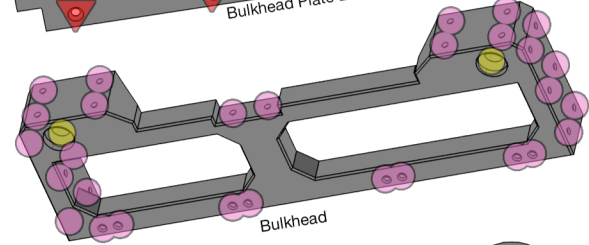

Bulkhead

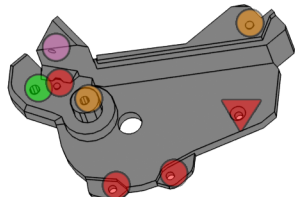

Front Cover Plate (2)

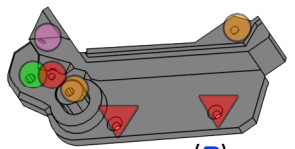

Rear Cover Plate (2)

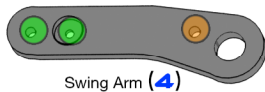

Swing Arm (4)

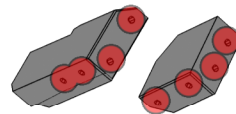

Servo Mounts (4)

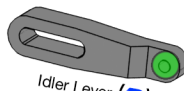

Idler Lever (2)

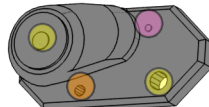

Idler Mount (2)

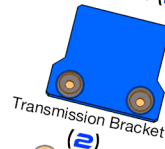

Transmission Bracket (2)

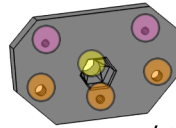

Suspension Mount (4)

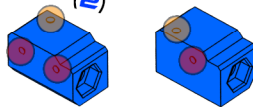

Transmission Mount L/R

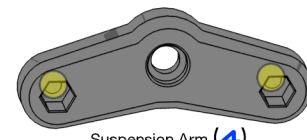

Suspension Arm (4)

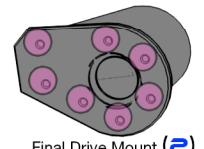

Final Drive Mount (2)

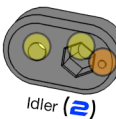

Idler (2)

Suspension Upgrade

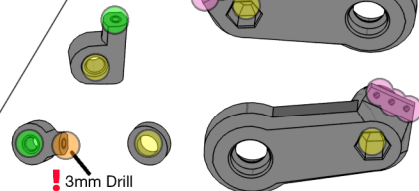

! 3mm Drill

*Holes come printed with countersunk holes but need to be smoothed out. LIGHTLY use a countersink bit in the holes marked with: ▽

CAB DRILL GUIDE

DRILL SIZE KEY

CAB KIT

○ = Drill Hole

▽ = *Countersink

● - 5/64" (2.0mm)

● - 3/32" (2.4mm)

● - 3mm

● - 9/64" (3.6mm)

● - 5/32" (4.0mm)

● - 5mm

Drill with the sizes shown to avoid splitting or stripping out threads.

Some parts have a right and left, mirror drill holes to both sides.

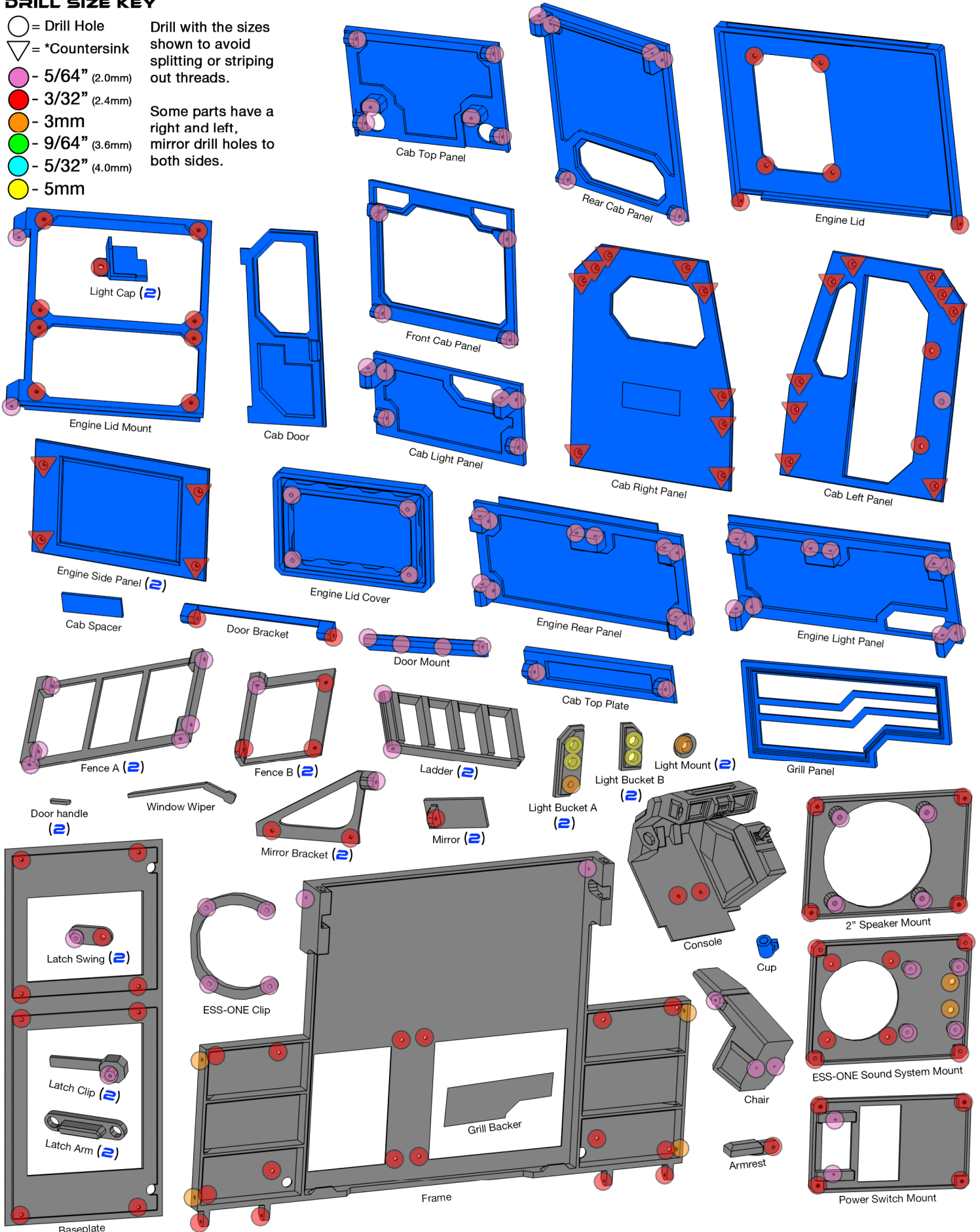

*Holes come printed with countersunk holes but need to be smoothed out. LIGHTLY use a countersink bit in the holes marked with: ▽

DUMP BUCKET DRILL GUIDE

DUMP BUCKET KIT

DRILL SIZE KEY

○ = Drill Hole

▽ = *Countersink

● - 5/64" (2.0mm)

● - 3/32" (2.4mm)

● - 1/8" (3.2mm)

● - 9/64" (3.6mm)

● - 5/32" (4.0mm)

● - 5mm

Drill with the sizes shown to avoid splitting or stripping out threads.

Some parts have a right and left, mirror drill holes to both sides.

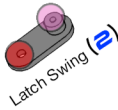
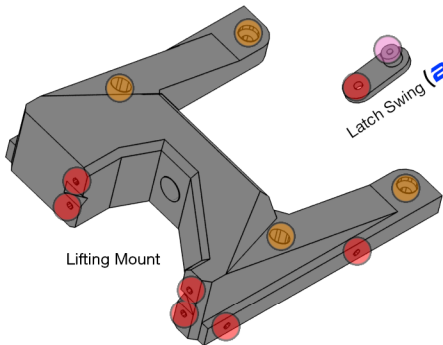
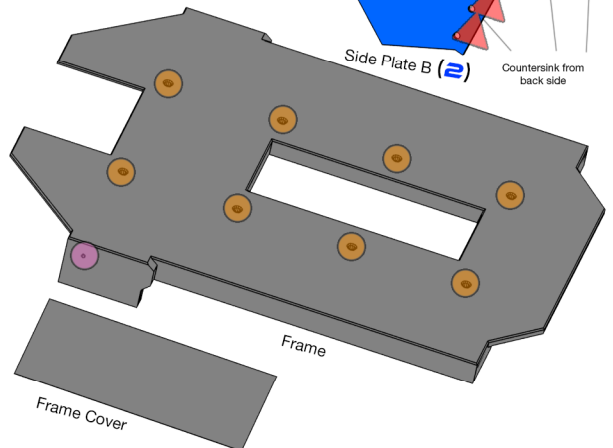
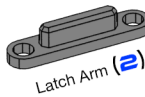
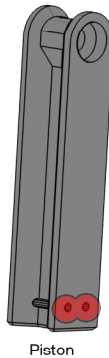
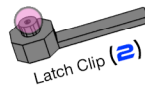
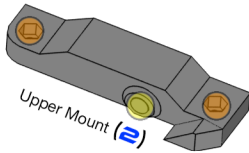
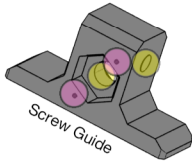
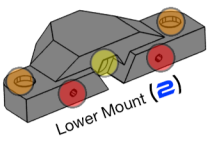
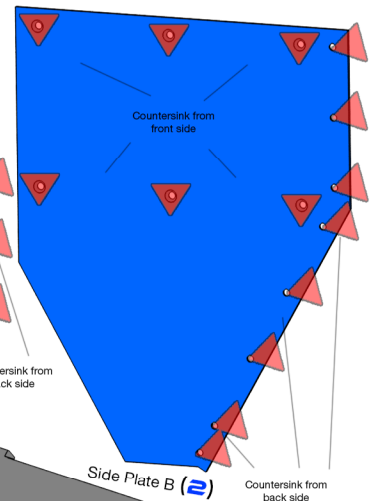
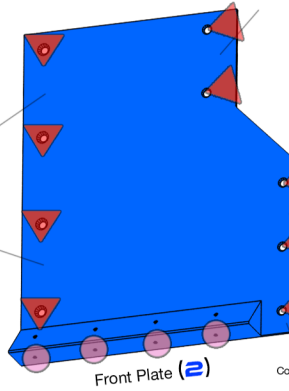
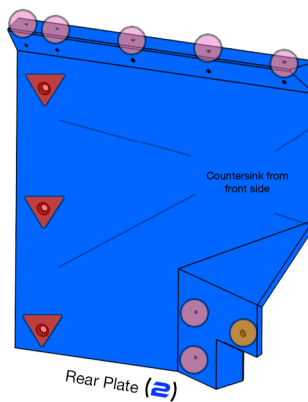
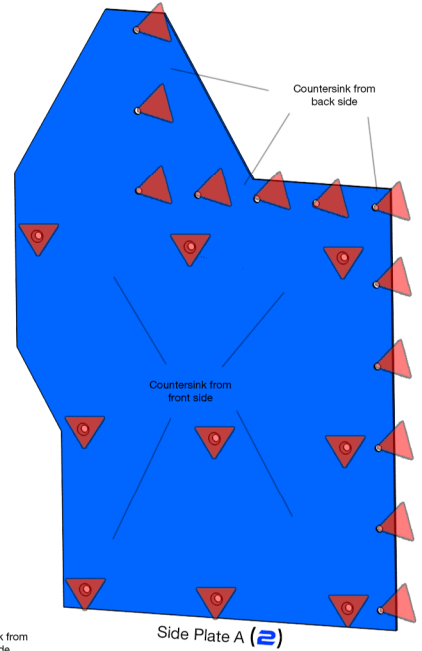
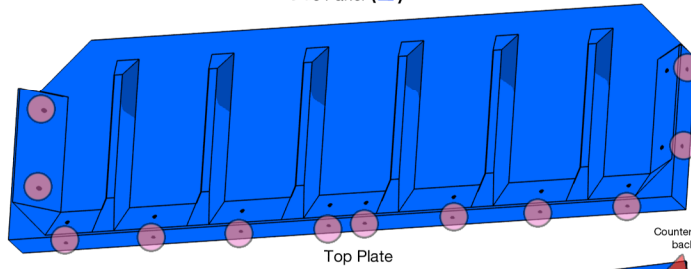
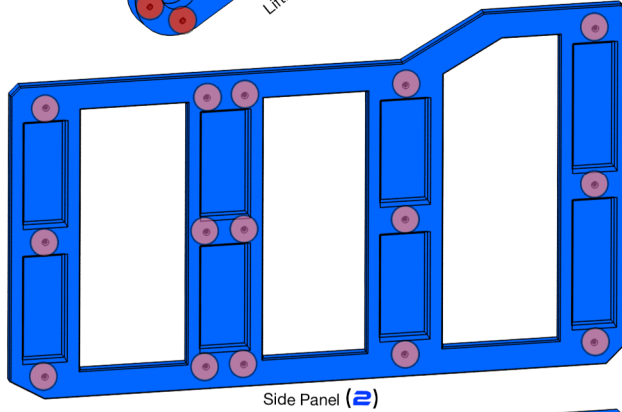
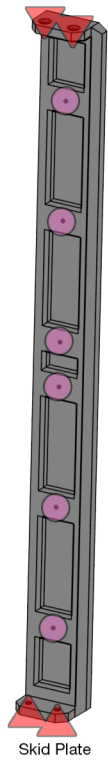
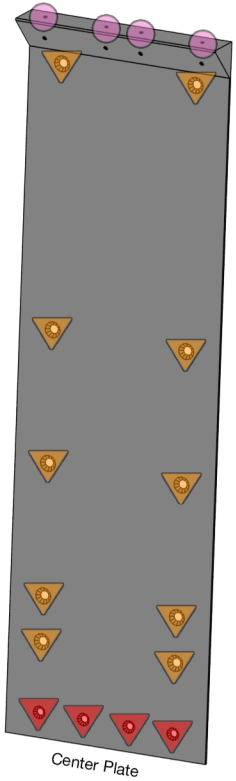
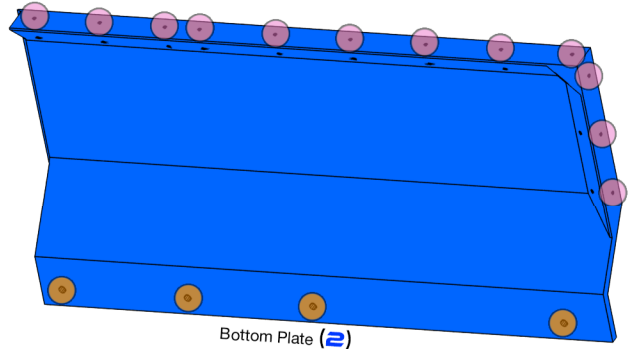
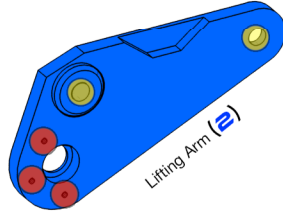
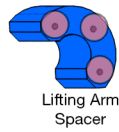
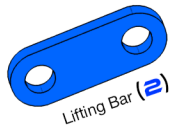

*Holes come printed with countersunk holes but need to be smoothed out. LIGHTLY use a countersink bit in the holes marked with: ▽

MISC DRILL / HARDWARE

DRILL SIZE KEY

○ = Drill Hole

▽ = *Countersink

● - 1/16" (1.6mm)

● - 5/64" (2.0mm)

● - 3/32" (2.4mm)

● - 1/8" (3.2mm)

● - 9/64" (3.6mm)

● - 5/32" (4.0mm)

Drill with the sizes shown to avoid splitting or stripping out threads.

Some parts have a right and left, mirror drill holes to both sides.

TRACKS

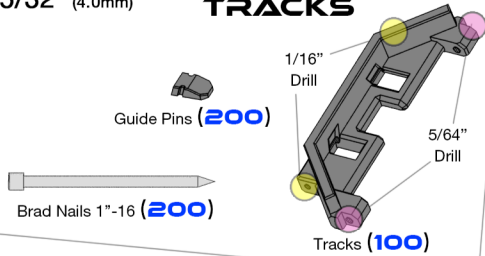

BLOWER BRACKET

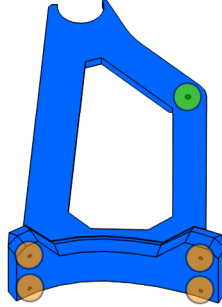

MISC PRODUCTS

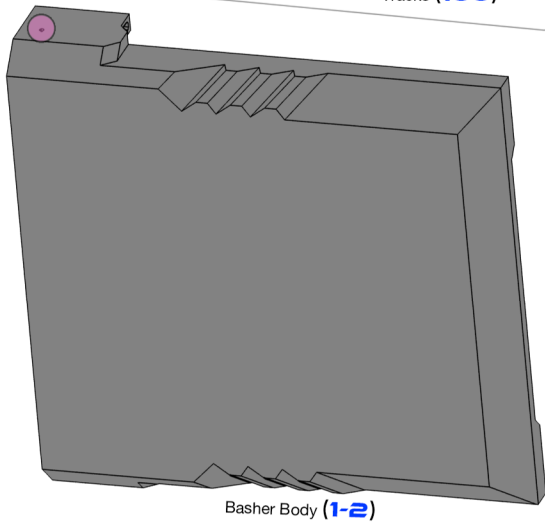
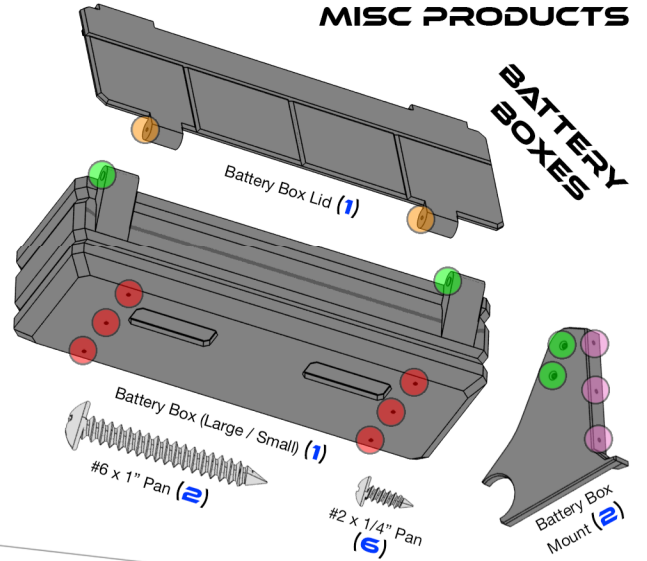

BASHER BODY

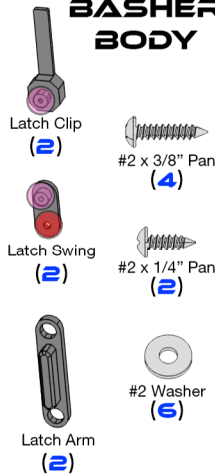

BLANK / CUSTOM BODY

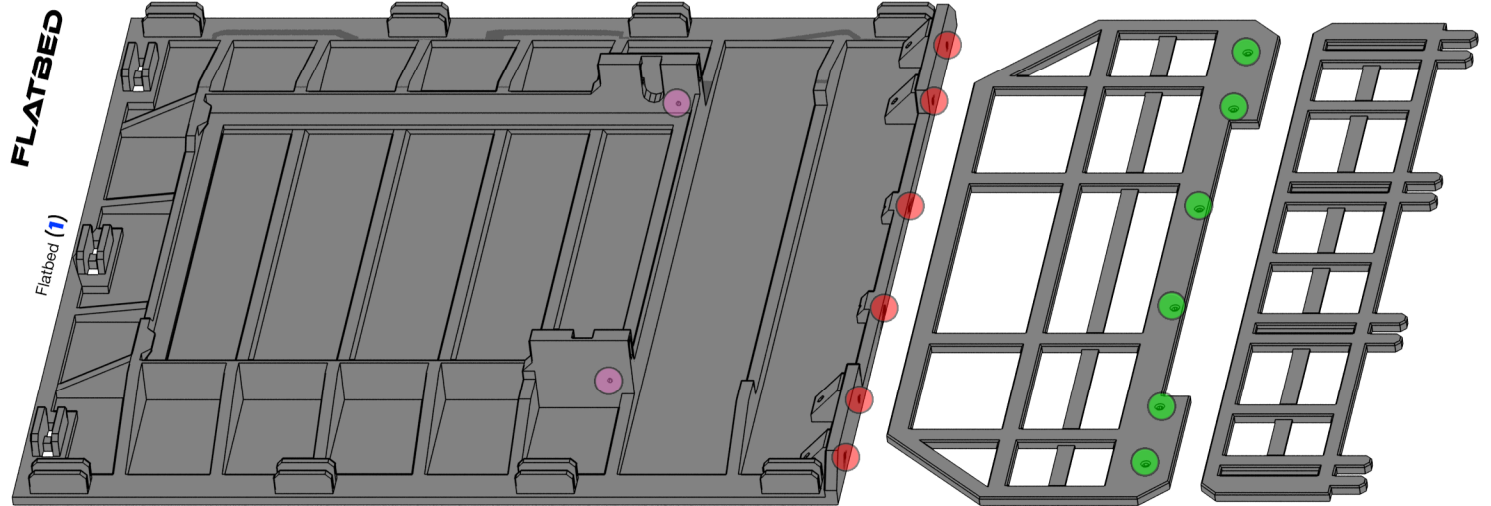
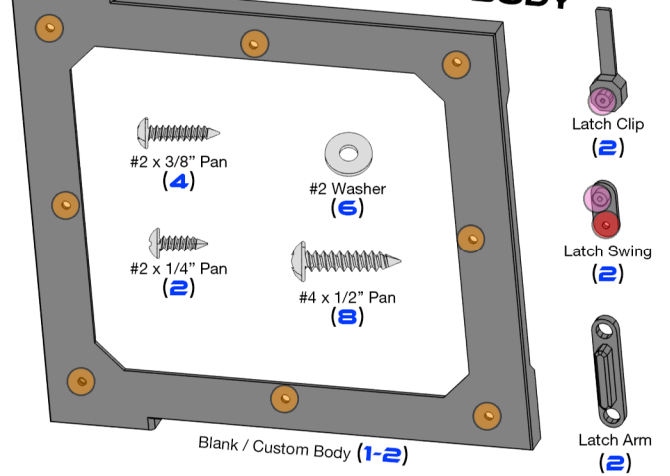

BLIZZARD PLOW HARDWARE

